

Cryogenic-Globe Valves with Pneumatic Actuator, 725 P.S.I.

Bronze body and stainless steel topwork (internal parts bronze)

Actuator - air opens, spring closes or contrary

“live loaded” gland packing

“cleaned and degreased for oxygen service ” - the actuator is not cleaned and degreased for oxygen

Part No. 01313.X.1017

Complete with stainless steel pipes acc. to DIN EN 10216-5 or ASTM A312

Available accessories:

- Solenoid valve
- Limit switch
- Electropneumatic positioner etc.

Available options - on request only:

- Actuator “cleaned and degreased for oxygen service ”
- Electric actuator
- Bellow sealed option
- Valve with control disc (tapered design)



GVPAPBS Series

Applications:

Approved for air gases, vapours and cryogenic liquefied gases incl. LNG.

Working temperature: -196°C / -321°F (77K) up to +120°C / +248°F (393K)

Materials	ASTM
1 Body	B 62 UNS C83600
2 Valve seal	PTFE / Carbon filled (25%)
3 Disc	B 283 UNS C38500
4 Bonnet gasket	PTFE
5 Headpiece	A 276 Grade 304
6 Bolts	A 194 B8
7 Elongation tube	A 213 TP 321
8 Stem	A 276 Grade 304
9 Gland packing	Graphite / PTFE
10 Gland nut	B 283 UNS C38500
11 Pillars	A 276 Grade 304
12 Bush	B 103 UNS C51900
13 Stainless steel stubs	A 312 TP304L

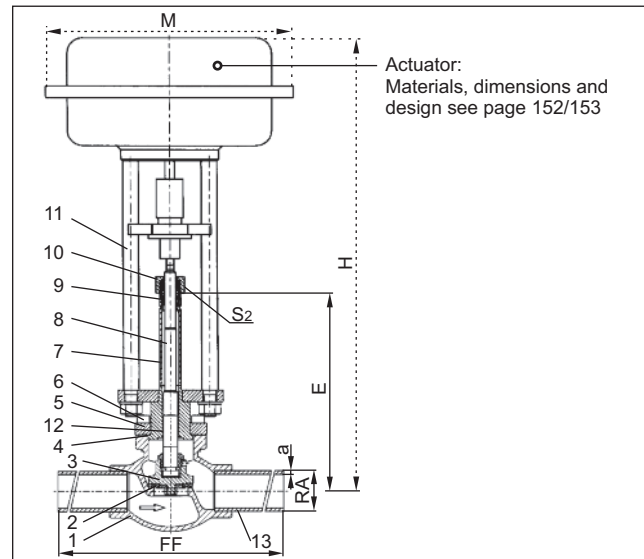

Standard marking acc. to Pressure Equipment Directive 97/23/EG (PED).



Marking acc. to Directive 99/36/EG (TPED) will only be carried out by written notice on purchase order.



Type 01313 – Standard design	Technical data									
	Inches	3/8"	3/8"	1/2"	3/4"	1"	1 1/4"	1 1/2"	2"	
Nominal size	.X.	1012	1017	1521	2027	2533	3242	4048	5060	
Dimensions code	.X.	1012	1017	1521	2027	2533	3242	4048	5060	
Face-to-face dimension	FF	210	210	235	235	265	265	290	310	
Height	H	dependent on actuator								
Length	E	195	195	195	200	200	230	230	235	
Outside pipe -Ø DIN EN ISO 1127	RA	12.0	17.2	21.3	26.9	33.7	42.4	48.3	60.3	
Wall thickness pipe DIN EN ISO 1127	a	1.0	2.3	2.6	2.9	3.2	3.2	3.6	3.6	
Outside pipe -Ø ASTM A312	RA	–	17.15	21.34	26.67	33.4	42.16	48.26	60.33	
Wall thickness pipe ASTM A312	a	–	S40	S10	S10	S10	S10	S10	S10	
Actuator-Ø	M	dependent on actuator								
Wrench size across flats	S ₂	30	30	30	30	30	36	36	36	
Weight w/o actuator	LBS.	3.85	4.97	5.72	6.6	7.7	10.34	14.74	21.56	
CV-Value	gal/min	1.9	2.6	5.0	7.8	13.4	14.1	26.3	43.2	

Dimensions in mm